

DUPLIX STAINLESS STEEL MESH FABRIC

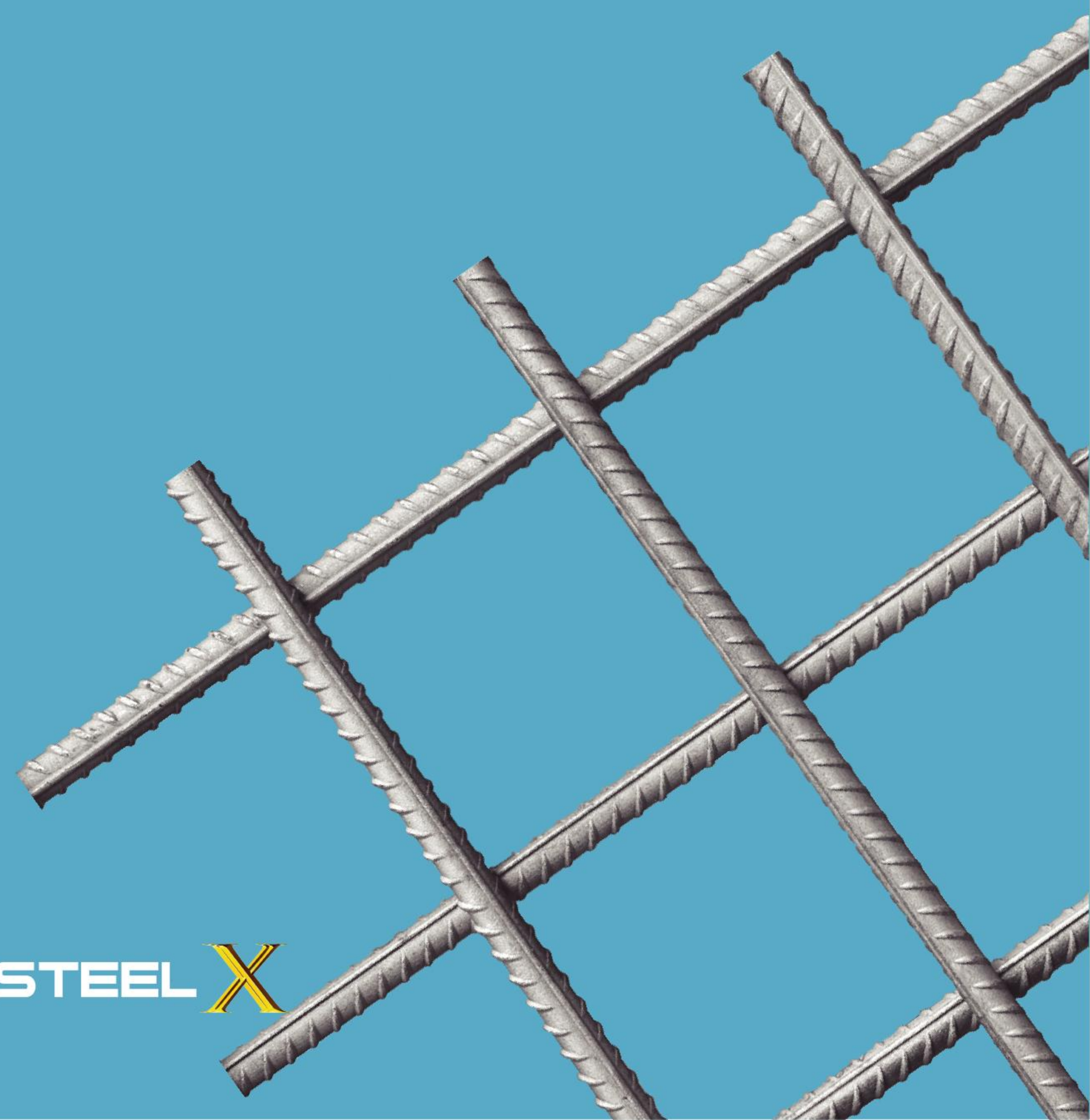

FUSTEEL X

Fusteel lean duplex stainless steel rebar is produced and processed by CARES approved fusteel, using ribbed bar to BS 6744 to the mesh patterns given in BS4483.

Duplex stainless steel mesh fabric, fabricated from rebars and welded at all intersections, widely applied in reinforced concrete constructions in marine environment and deicing salt using area, typically used as anti-cracking mesh in bridge deck pavement and bridge piers.

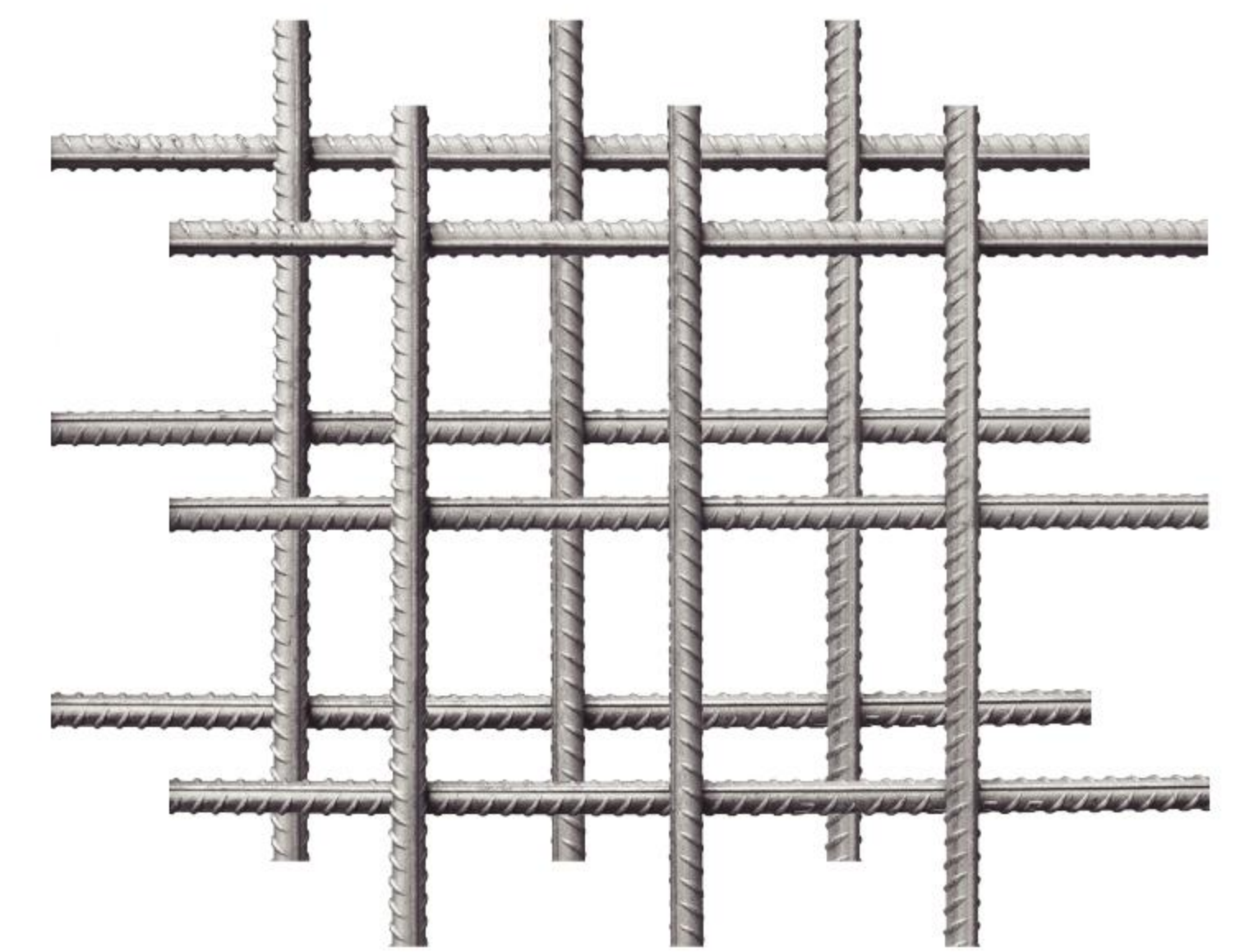

Fusteel steel Designation	EN	ASTM
Duplex 2304	1.4362	S32304

BS 4483 Reference	Longitudinal bars			Transverse bars			Mass
	Nominal bar size	Pitch	Area	Nominal bar size	Pitch	Area	
	mm	mm	mm ² /m	mm	mm	mm ² /m	kg/m ²
Square mesh							
A393	10	200	393	10	200	393	6.16
A252	8	200	252	8	200	252	3.95
Structural mesh							
B1131*	12	100	1131	8	200	252	10.9
B785	10	100	785	8	200	252	8.14
B503	8	100	503	8	200	252	5.93
Tolerances							
length and width			±25mm or ±0.5% whichever is the greater				
bar pitch			±10mm or ±5% whichever is the greater				
overhangs			to be agreed at the time of enquiry				

* Highly recommended by fusteel